

AIRJET 12/24

Climatizzatore 12V/24V DC
12V/24V DC Air conditioner
3.700-9.000 / 5.400-11.400 BTU/h

Awarded by



UCINA
CONFINDUSTRIA NAUTICA

ADI ADI ASSOCIAZIONE
PER IL DISEGNO
INDUSTRIALE



Display e comando remoto
Display and remote controller

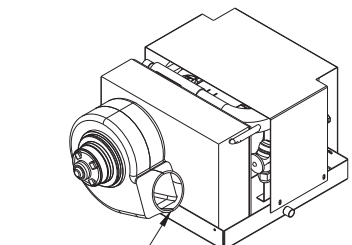
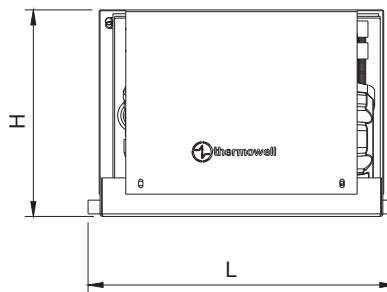
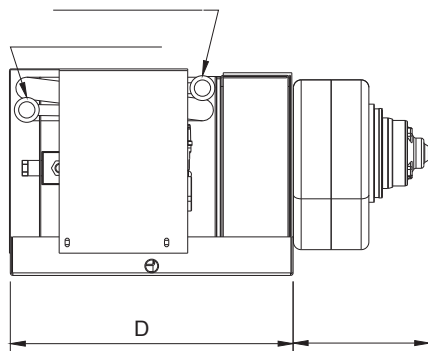

Kit accessori standard Standard Accessories kit

- Tubazione flessibile coibentata diam. 82 mm (1,5 m)
- Bocchetta di mandata circolare bianca orientabile e chiudibile diam. 100 mm
- Manicotto di giunzione 100/80mm
- Fascette stringitubo (2)
- Griglia di ripresa bianca 300x200mm
- Tubazione spiralata diam. 20mm (3 m)
- Filtro mare in plastica
- Portagomma maschio 1/2"x 20mm
- Rubinetto 1/2" femmina/femmina
- Presse a mare 1/2",
- Scarico a mare 1/2"
- Fascette stringitubo acciaio inox 17x32mm (8)
- Tubazione scarico condensa diam. 16mm (1,5 m)
- Staffette di fissaggio (3)



- Flexible insulated duct diam.102mm (2,5 m)
- PVC circular white round closeable supply grille diam. 100mm
- PVC hose clamps 450x8mm (2)
- White return air grille diam. 300x200mm
- In line junction 100-80mm
- PVC hose with spiral reinforcement 20mm (3 m)
- Sea water plastic strainer
- Male hose connector 1/2"x20mm
- Ball valve 1/2" female/female
- Sea water intake 1/2"
- Sea water discharge 1/2"
- Stainless steel hose clamps 17x32mm (8)
- Condensate drain pipe (1,5 m)
- Angular steel brackets (4)

Caratteristiche tecniche Specifications

Model	AirJet 12		AirJet 12+		AirJet 24		AirJet 24+	
Nominal cooling capacity BTU/h	3700	6250	6300	9000	5400	7400	7400	11400
Nominal cooling capacity W	1080*	1790	1790	2580	1580*	2170	2170*	3343
Power supply	12 V DC				24 V DC			
Full load amps FLA A/h	40*	65	65*	80	22	42	42	66
Power input kW	0,6	0,8	0,8*	1,1	0.5	1	1*	1,6
Refrigerant charge g	230				240			
Blower diameter mm	80				100			
Air flow mc/h	500				650			
Sea water connections mm	19				19			
Water flow l/min	6		7,5		9		10	
Compressor	scroll BLDC				scroll BLDC			
Wiring diameter mm	10				10			
Net weight kg	17				18			
Sizes self contained version LxDxH mm	380x484x240				354x480x290			
Sizes split version LxDxH mm	Condensante 240x337x240 Evaporante 331x246x240				Condensante 240x337x280 Evaporante 331x246x240			

Potenze e dati elettrici sono relativi ad una temperatura di evaporazione di 7,2°C e di condensazione di 37,8°C. Tutte le dimensioni +/- 10 mm. Tutti i pesi +/- 10%. Disponibile il Twin Kit e il Deluxe Kit come per il modello IZY.

BTU and electrical data are based on 45F / 7,2°C evaporating temperature and 100F / 37,8°C condensing temperature in cooling mode. All dimensions +/- 0,39 in. All weights +/- 10%. Available the Twin kit and Deluxe kit as per IZY model.

Schema di installazione Installation scheme

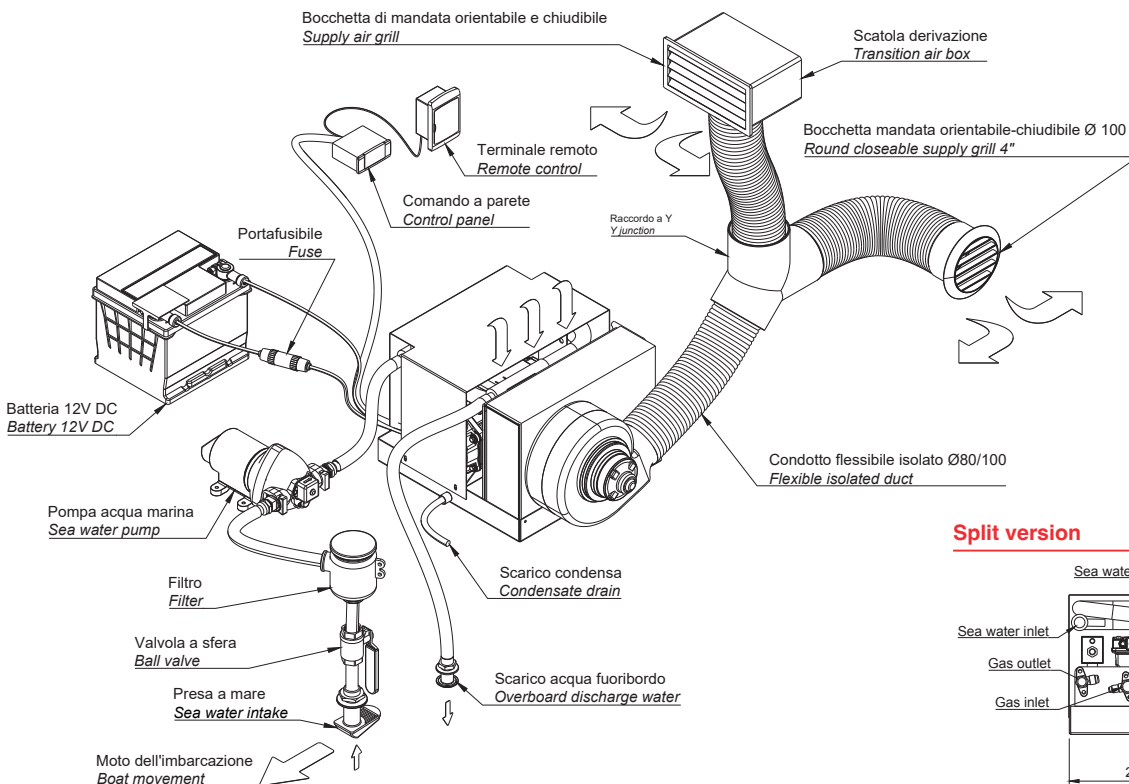

Split version

